

ACTIVATION

Ekey dLine Scanner



Ekey electronics in our doors is always complete and fully connected, the network ends with a regular power supply HDR-60 (24V for KFV and GU locks, 12V for Winkhaus locks). Connecting the power supply to power as well as reconnecting the power supply with the cable transfer/electric latch is a customer's responsibility – we suggest to have an electrician do the wiring. See below for a quick manual.

Connection plan for motor-based solution

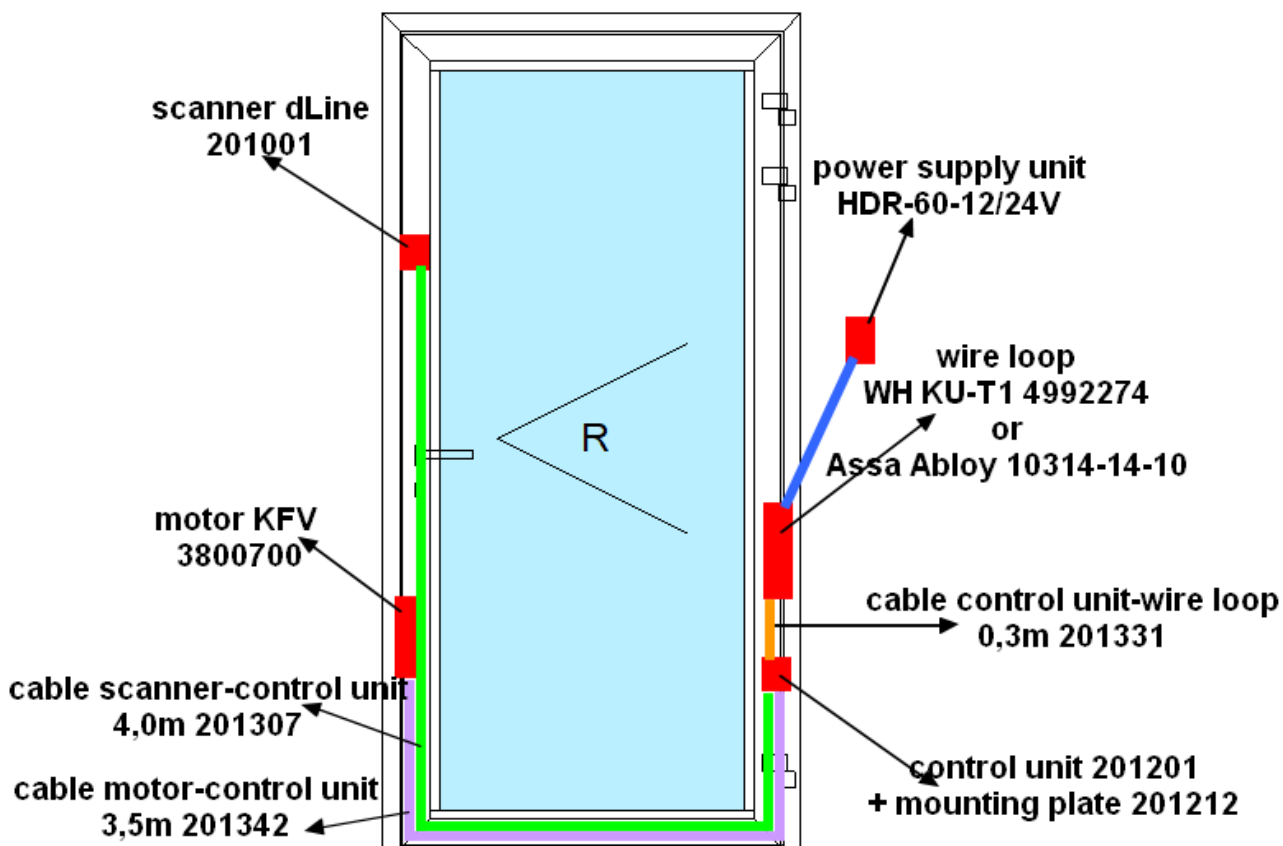

Connection plan for electric latch

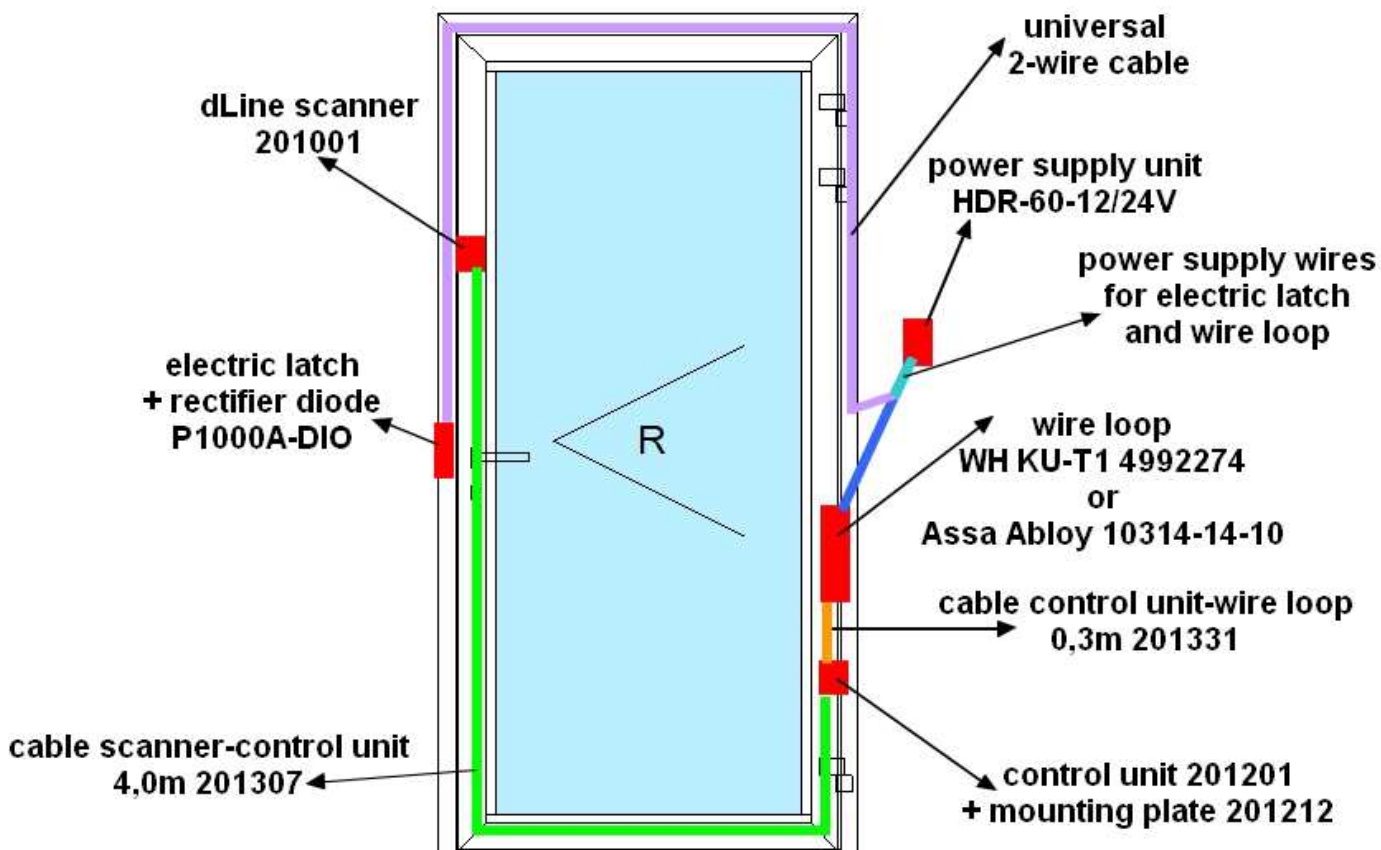

Power supply specification:

- voltage: 85-264VAC lub 120-370VDC
- montage DIN TS35 / 7.5 lub 15
- work temperature from -30 to +70°C
- 0 load power consumption <0.3W
- adjustable voltage
- overload and overvoltage protection
- air cooled
- compatible with LPS
- II isolation class
- LED work signal
- compliant with standards UL-60950-1/508/1310, EN60950-1/61558-2-16
- 3 year warranty

HDR-60-12	12V, 0~4.5A	+/-1%	120mV	88%	52.5x90x54.5mm
HDR-60-24	24V, 0~2.5A	+/-1%	150mV	90%	52.5x90x54.5mm

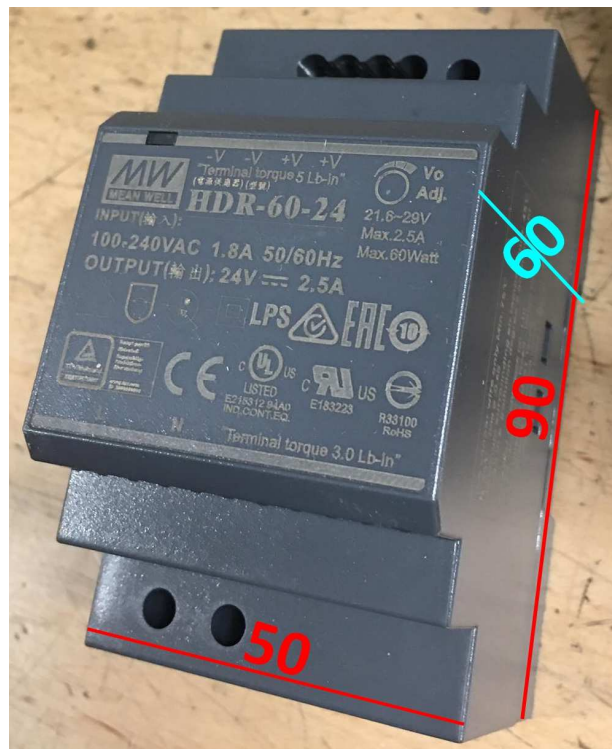

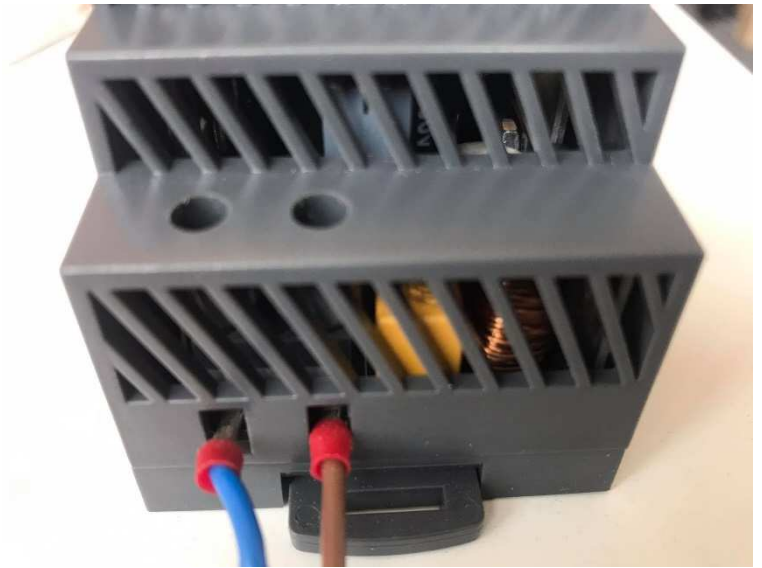

Left photo:

- **brown** – minus from electric latch (only available for doors with electric latch, not present for motor-based locks)
- **thin brown** – minus from cable transfer
- **thin white** – plus from cable transfer
- **blue** – plus from electric latch (only available for doors with electric latch, not present for motor-based locks)

Right photo:

- **blue** and **brown** – L and N – doesn't matter which one is first

Wires shown on the right photo are not provided by Awilux. It can, for example, be connected to a regular 230V plug.

In production, the scanner/keypad gets activated and tested, then reset back to factory settings. After plugging the scanner/keypad in on construction site, it needs to be activated and configured.

- first plug-in

ekey bionyx mobile app is necessary for activating the dLine scanner.

- plugging in correctly should make the scanner glow blue

- pick „Myself” activation, find and choose the scanner

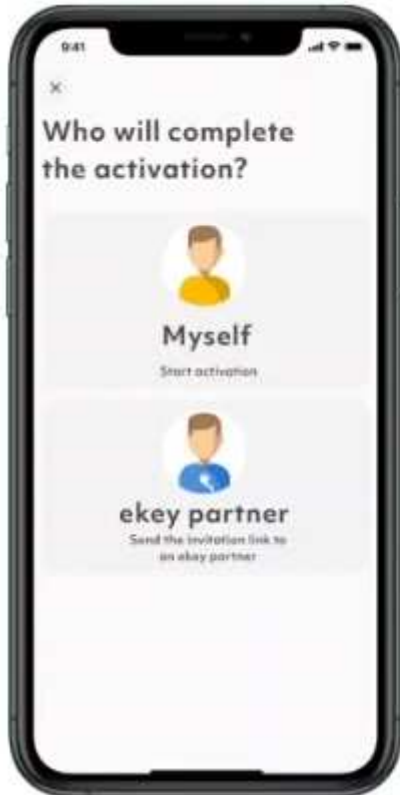

- after it's paired, the scanner will glow blue – pick „Yes”, find WIFI, connect to it

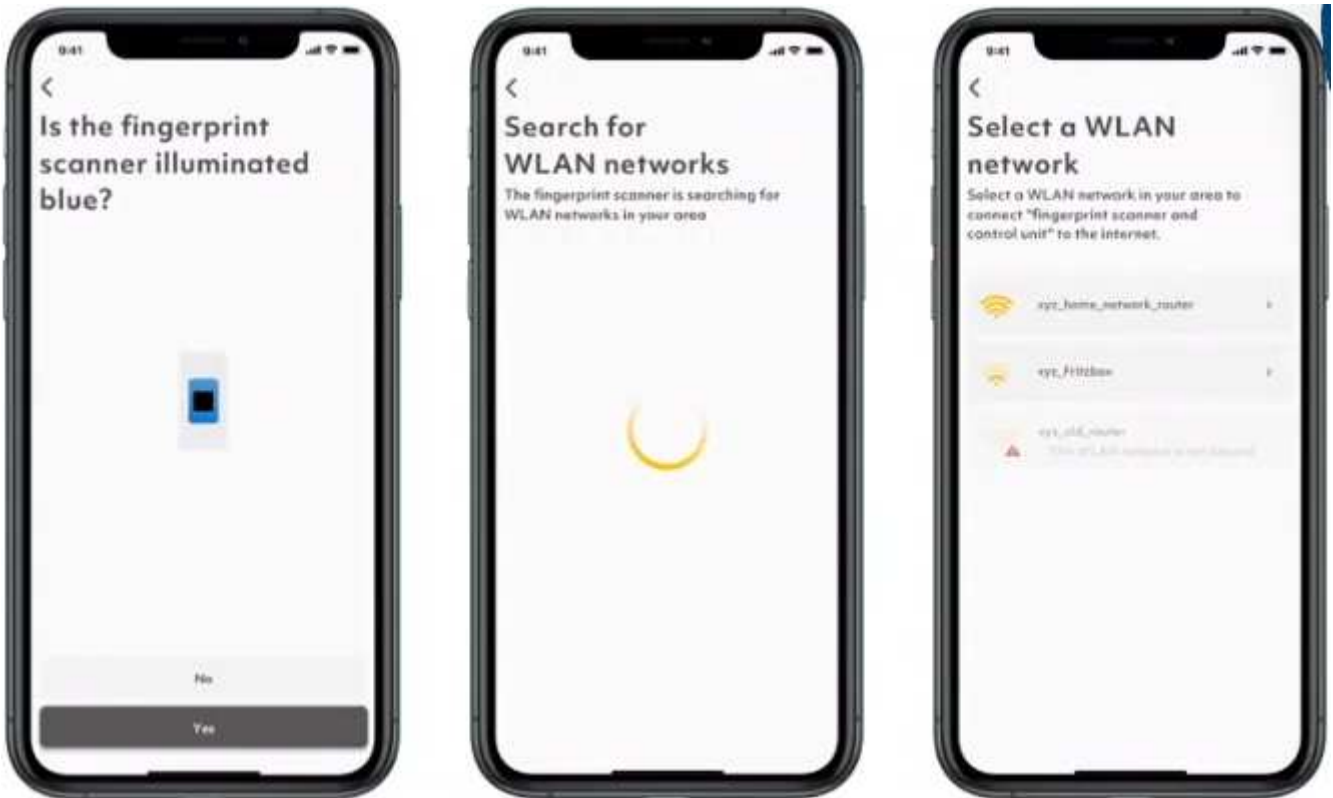

- create an access point – ex. „Front Door”



- name the scanner and the control panel

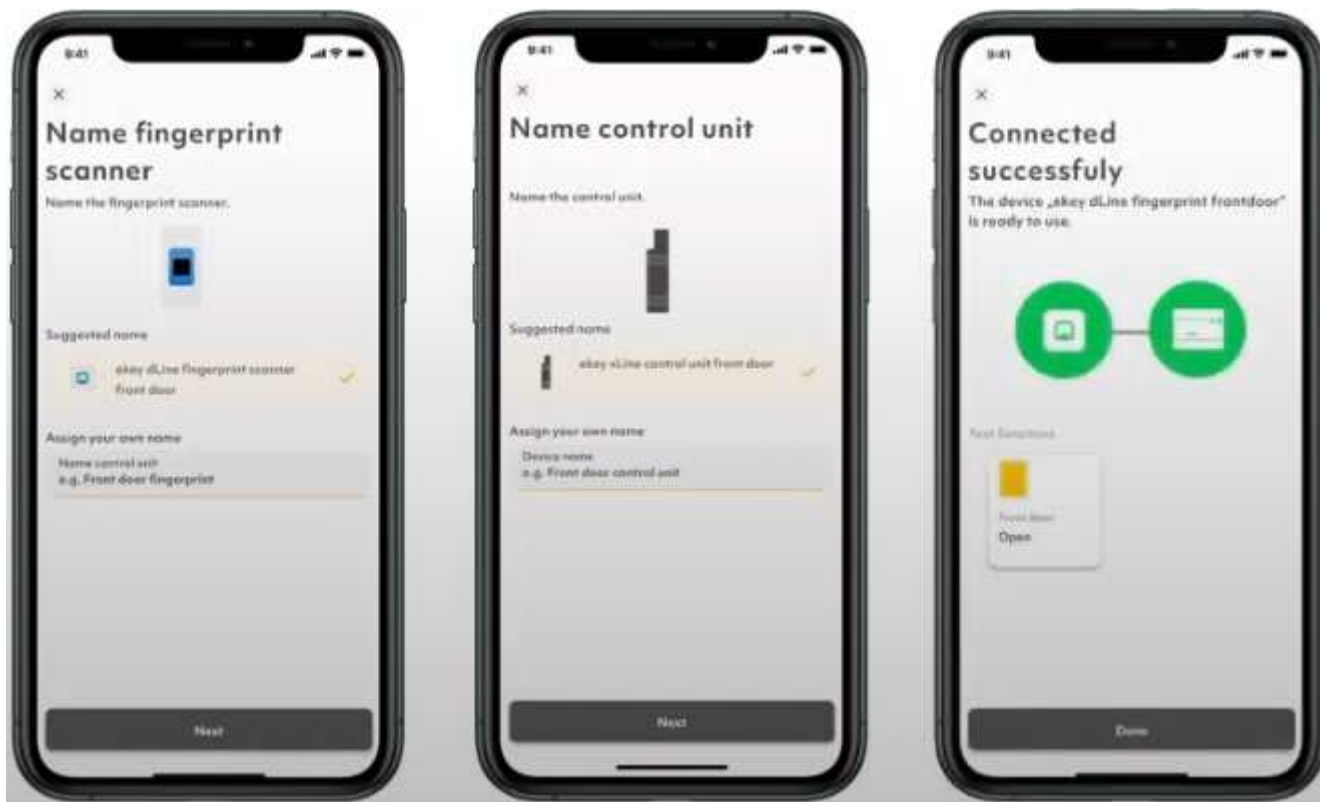

- two green rings mean that everything is fully connected

- add an administrator or a user

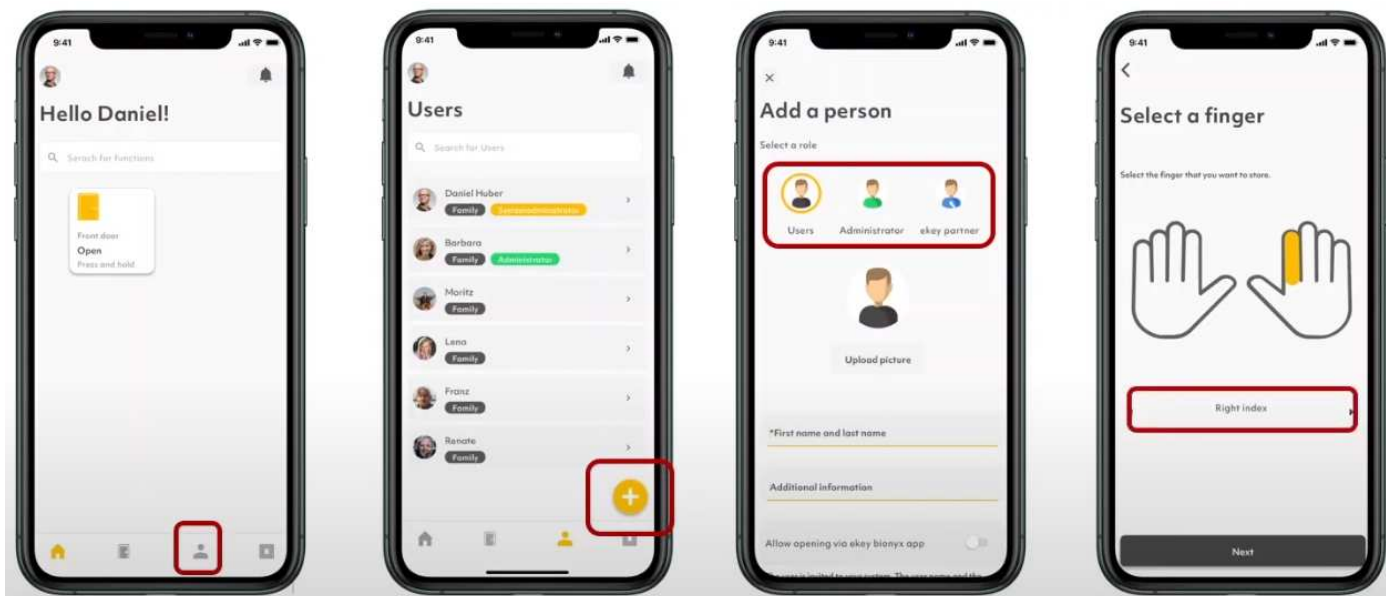

- make sure you place your fingers the same way you do it with the mobile phone finger scanner – do not slide, just hold



- if any of the steps goes wrong – the control panel should be restored back to factory settings and all the steps should be repeated. Make sure the panel is powered while resetting.

The control panel is located on the hinge side, right under the cable transfer spring, above a lower hinge. The panel is mounted on a black, plastic backplate, which needs to be unscrewed and carefully pulled out.

Control panel is a small, 10 cm black box. See below.

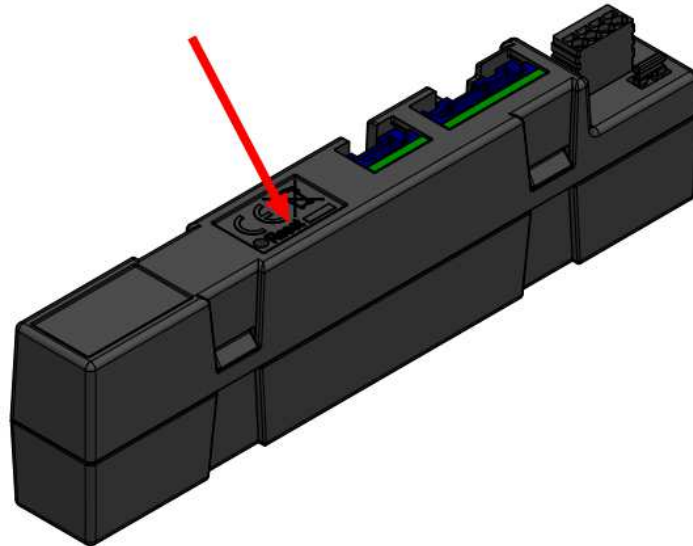

- the box does not need to be dismantled, all you need to do is to stick a small wire into the hole and hold it for about 4 seconds. Make sure the box is connected to power. The reset hole is located on the top of the box (4-PIN plug side). See pictures for reference.

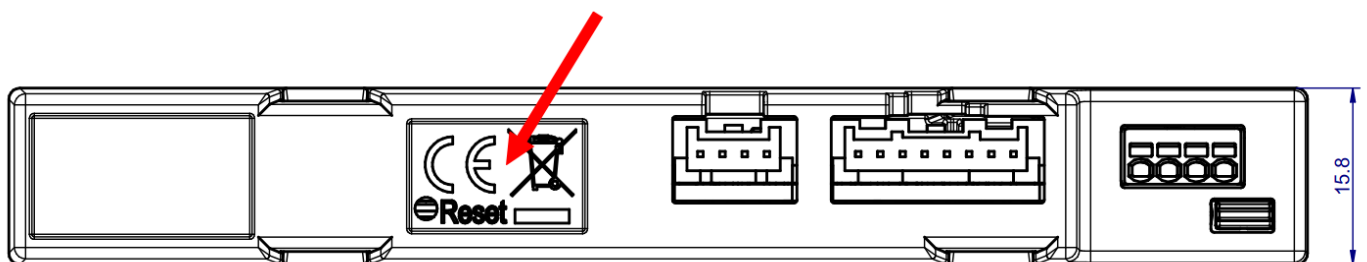

More detailed instructions should be attached to your order.

This instruction, as well as the Ekey operating instructions, can all be found on our website:

<https://www.awilux.pl/>